

OUTBOARD



**BRIDGE YACHTS LTD.**  
SHIP'S STORE & YACHT BROKERS  
49 Harbour St. Port Dover, Ontario N0A 1N0  
Tel: (877)583-3199 [www.BridgeYachts.com](http://www.BridgeYachts.com)





# TRUST

*noun: firm belief in the reliability, ability, or strength of something.*

Every adventure on the water depends on reliable outboard performance. Keep looking forward with confidence, and only back to reminisce, with Yamaha behind you.

It is in the moments, listening to water lapping against the hull of the boat and breathing in the smell of fresh air on a calm evening, that we realize getting away means embracing time with those closest to us. Yamaha has your back so you can focus on the things that matter most.

Trust how far you've come and have faith in how much further you can go with your Yamaha.

TABLE OF CONTENTS

Helm Master EX	4	1.8L V MAX SHO	15
XTO Offshore	6	High Thrust	16
4.2L V6	7	Jet Drive	17
Inline 4-Stroke	8	Specifications	18
Midrange 4-Stroke	10	Accessories	23
Portable 4-Stroke	11	Yamalube®	34
4.2L V MAX SHO	13	Yamaha Financial Services	35
2.8L V MAX SHO	14		



# NEW!

HELM MASTER EX

## GREATER CONFIDENCE ON THE WATER

Helm Master EX offers boaters customizable, integrated boat control with more ease and convenience than ever before. Available for single through quad applications, Helm Master EX brings ultimate boat control and fishability to a wider variety of boaters. Compatible with Yamaha Digital Electronic Control models from 150hp to 425hp.

Yamaha Autopilot acts as a gateway for convenient features and benefits to optimize boat control and operation.

Fish directly below the boat, wait for a bridge to open or easily maintain position at a fuel dock with SetPoint®.

Buoyant wireless fob allows use of keyless start/stop push-button ignition panels and On/Off switch for Y-COP® anti-theft.

HELM MASTER EX

### DIGITALELECTRIC CONTROL (DEC)

Redesigned with a sleek new look for greater ergonomic comfort and new capabilities for boaters who may not want the full Helm Master EX suite of capabilities.

### YAMAHA'S DIGITAL ELECTRIC STEERING (DES)

Can now be added to most current Yamaha DEC-controlled outboards for single through quad installations, and offers a clean, more spacious bilge.

### JOYSTICK

Features modern styling, premium feel and optimal ergonomics, while providing smoother shifting and single-function buttons for intuitive operation.



XF425

# XTO OFFSHORE

Designed from the ground up to be smarter, more powerful and more efficient, the 5.6-litre V8 XTO Offshore is much more than an outboard; it's a fully integrated power system. And it's created an entirely new class of extreme offshore power and features a five-year limited warranty, because reliability and confidence are important when you're taking control of the open water.



1. Industry-exclusive fully integrated electric steering system.
2. Up to 104 amps\* of total (gross) power.
3. In-water gear lube change system.

\*B-Generation Model



F300 | F250 | F225  
MECHANICAL OR DIGITAL

## 4.2L V6

Take to the water with Yamaha's V6 four-stroke outboards. Purpose-designed for offshore use, they all feature 4.2 litres of class-leading V6 displacement with significantly less weight than their predecessors. Boaters also have the option of mechanical control versions of these legendary outboards – making them a great repower solution.

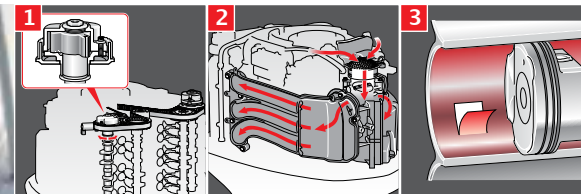

1. Variable camshaft timing delivers awesome hole shot and midrange acceleration.
2. Electronically controlled throttle valve and the precision multi-point fuel injection system work together for optimum power and fuel efficiency.
3. Light and strong plasma-fused sleeveless cylinders increase displacement, power and torque.





F200 | F175 | F150  
MECHANICAL OR DIGITAL

# INLINE 4-STROKE

Powerful, light, nimble and compact, boaters know the proven reliability of Yamaha's I-4 family is unmatched for everything from pontoons to deep-V hulls. Though the bestselling F150 is the original fan favourite, its streamlined engineering inspired impressive successors – like the powerful F175 and the forward-thinking F200. Extremely versatile, this series is ready for your next adventure!

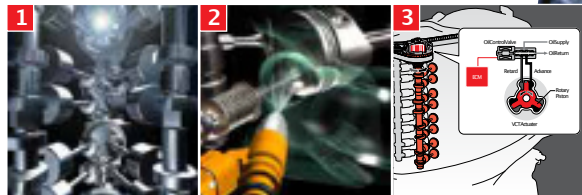

1. A proven 16-valve DOHC in-line design, with four valves per cylinder, maximizes efficiency and power.
2. Precision Multi-Point EFI is controlled by the Engine Control Module to continually adjust the fuel/air mix to properly match engine load and speed.
3. Variable Camshaft Timing and four tuned intake tracks increase low- and mid-range torque (F200 only).



F115 | F90 | F75

# INLINE 4-STROKE

The F115, F90 and F75 are a powerful part of Yamaha's lineup — and your boating experience. These reliable performers sport 1.8-litre displacement and DOHC or SOHC designs with four valves per cylinder, giving them exceptional volumetric efficiency and lighter weights. Experience the artful blend of power, quiet performance and amazing throttle response for yourself.

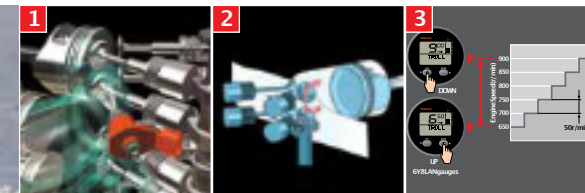

1. Precision Multi-Point Electronic Fuel Injection optimizes performance and efficiency.
2. Four valves per cylinder increases volumetric efficiency, improving engine combustion.
3. Yamaha's Variable Trolling RPM Switch (VTS™) allows for precision speed adjustments in 50-rpm increments.





F70 | F60 | F50 | F40 | F30

# MIDRANGE 4-STROKE

An impressive and evolving collection of 3- and 4-cylinder engines, Yamaha's midrange outboards have an electronic multi-point fuel injection system and single throttle valve design that precisely control air flow. The entire midrange line is engineered to provide turnkey starts and fast, efficient power for a range of inshore boats.

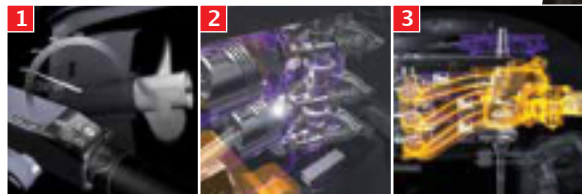

1. Adjust trolling speeds in 50-rpm increments with the push of a button on the optional Command Link tachometer or optional Multi-Function Tiller handle.
2. The lightweight compact SOHC design exchanges intake and exhaust gases for responsive power and optimal fuel efficiency.
3. Air enters each cylinder through "pulse-tuned" intakes that provide air for maximum density and power.



F25 | F20

# PORTABLE 4-STROKE

Meet Yamaha's F25 and F20 outboards. These compact four-strokes have an unrivalled power-to-weight ratio for greater torque and acceleration that you can feel immediately out on the water. Available in a variety of specifications with a long list of unique features and Yamaha's renowned reliability, the F25 and F20 leave the competition in their wake.

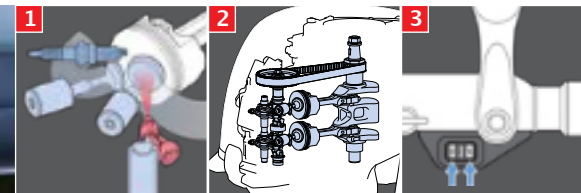

1. Battery-less Electronic Fuel Injection ensures easy starting. (manual start models)
2. Lightweight in-line SOHC twin-cylinder design.
3. Yamaha's Variable Trolling RPM Switch (VTS™), standard on all new generation F20/F25 tiller models, allows for precision speed adjustments in 50-rpm increments.





F15 | F9.9 | F8 | F6 | F4 | F2.5

# PORTABLE 4-STROKE

Yamaha's portable lineup provides nimble, lightweight, efficient power you can take with you wherever the day may take you. These small engines have big features to ensure easy operation and reliable performance, whether you're hopping to shore in a tender, skimming the marsh in a jon boat or pushing a sailboat 'til the wind kicks up.



1. Easy-to-pull recoil starter.
2. Yamaha's exclusive Oil Retention System (F2.5/4/6).
3. Built-in see-through fuel tank (F2.5/4/6).



\*F4 to F15



VF250 | VF250 X-SHAFT  
VF225 | VF200 X-SHAFT

# 4.2L V MAX SHO

The game changed forever when the Yamaha V MAX SHO first hit the water. Combining the strength of a two stroke and the clean-burning efficiency of a four stroke, these mighty machines were engineered with the competition in mind. With the recent additions of the 25-inch-shaft V MAX SHO 200 and 250, these power players are ready for a new game.

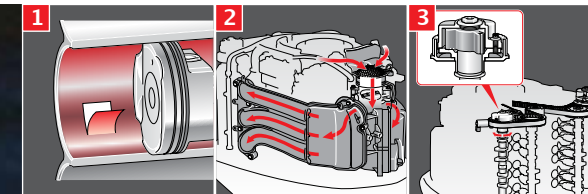

1. Light and strong plasma-fused sleeveless cylinders increases displacement, power and torque.
2. Micro-textured cylinder walls increase breathing efficiency while Precision Multi-Point Fuel Injection optimizes power and fuel efficiency.
3. Variable Camshaft Timing delivers awesome hole shot and midrange acceleration.





VF175 | VF175 X-SHAFT | VF150 | VF150 X-SHAFT

# 2.8L V MAX SHO

Competitors beware: the same exhilarating V MAX SHO performance bass anglers can't live without is also available for the multispecies crowd. Faster, stronger and smarter than the competition, this vicious pack of outboards is sure to change the minds of anglers who still prefer traditional two strokes.

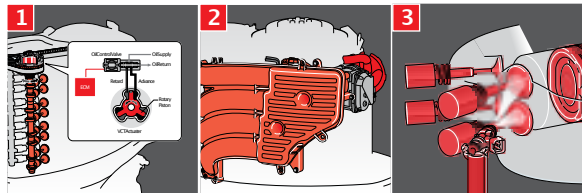

1. Variable Camshaft Timing delivers awesome hole shot and midrange acceleration.
2. Micro-textured cylinder walls increase breathing efficiency while Precision Multi-Point Fuel Injection optimizes power and fuel efficiency.
3. Four valves per cylinder maximizes combustion efficiency, delivering clean, quiet power and performance.



VF115 | VF115 X-SHAFT  
VF90 | VF90 X-SHAFT

# 1.8L V MAX SHO

The smallest of the high-performance V MAX SHO family packs a big punch with class-leading torque and acceleration. Both the 90- and 115-hp models are available in two shaft lengths so even more boaters can enjoy the benefits that have made this series famous ...or infamous.

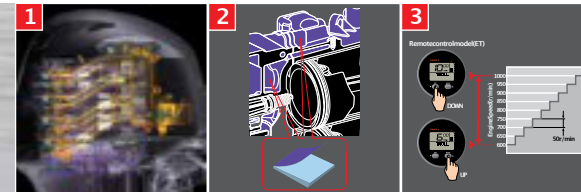

1. Precision Multi-Point Electronic Fuel Injection optimizes performance and efficiency.
2. Yamaha's Phaze Five™ paint system electro-deposits anti-corrosive paint on both the inside and outside passages of the engine block.
3. Yamaha's Variable Trolling Speed allows for precision speed adjustments in 50-rpm increments.





T60 | T50 | T25 | T9.9

# HIGH THRUST

Yamaha’s High Thrust four strokes are built for jobs that call for more muscle — like a trolling motor for big offshore boats. They’re strong enough to push a heavy boat thanks to specially designed dual thrust propellers that produce substantially more thrust than conventional outboards of the same horsepower using standard propellers.

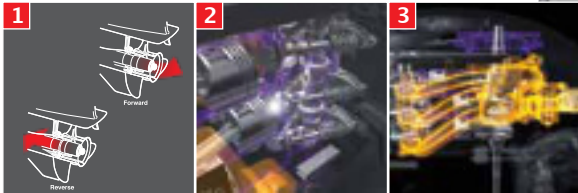

1. Large-diameter, low-pitch Dual Thrust™ propeller (standard – T9.9 and T25; optional – T50 and T60).
2. The lightweight compact SOHC design exchanges intake and exhaust gases for responsive power and optimal fuel efficiency.
3. Air enters each cylinder through “pulse-tuned” intakes that provide air for maximum density and power.



F150 | F115 | F90 | F60 | F40

# JET DRIVE

Yamaha’s Jet Drive four strokes can boldly go where no propped outboard would dare — shallows, rocky bottom rivers, whitewater rapids and shoals. With no prop or gearcase to get in the way, you can “off-road” on your next on-water adventure and you’ll feel like there’s no stopping you. These freewheeling four strokes are also impressively compact, lightweight and clean burning.

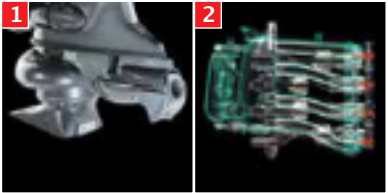

1. Manoeuvre around or pass over obstructions that would limit the travel of a conventional, propped outboard.
2. Precision Multi-Point Electronic Fuel Injection optimizes performance and efficiency.

**JETPOWER  
CONVERSION GUIDE**  
Yamaha Jet Power  
equivalency to propshaft  
horsepower is shown  
in the chart.

PROPSHAFT HP	JETPUMP HP
150	105
115	80
90	65
60	40
40	30



SPECIFICATIONS

FOUR STROKES								
MODEL	XF425	F300 F250 F225 DEC or MECH.	F200 DEC or MECH.	F175 DEC or MECH.	F150 DEC	F150 MECH.	F115	F90 F75
ENGINE TYPE	V8, 32-valve	V6(60°)	4cyl	4cyl	4cyl	4cyl	4cyl	4cyl
DISPLACEMENT	5559 cc (339.2ci)	4169 cc (254.4ci)	2,785 cc (170ci)	2,785 cc (170ci)	2,785 cc (170ci)	2,670 cc (163ci)	1,832 cc (111.8ci)	1,832 cc (111.8ci)
RPM RANGE	5,000- 6,000	5,000- 6,000	5,000- 6,000	5,000- 6,000	5,000- 6,000	5,000- 6,000	5,300- 6,300	5,000- 6,000
ALTERNATOR OUTPUT@ W.O.T.	104A* (gross)	70A(DEC) 50A(Mech)	50A	50A	50A	36A	35A	35A
COMPRESSION RATIO	12.2:1	10.3:1	10.3:1	10.3:1	10.3:1	9:1	10.0:1	10.0:1
FUEL/ INDUCTION SYSTEM	DOHC Fuel Injection VCT	DOHC Fuel Injection VCT	DOHC Fuel Injection VCT	DOHC Fuel Injection	DOHC Fuel Injection	DOHC Fuel Injection	DOHC Fuel Injection	SOHC Fuel Injection
LUBRICATION	Wet Sump	Wet Sump	Wet Sump	Wet Sump	Wet Sump	Wet Sump	Wet Sump	Wet Sump
IGNITION SYSTEM	TCI Micro Computer	TCI Micro Computer	TCI Micro Computer	TCI Micro Computer	TCI Micro Computer	TCI Micro Computer	TCI Micro Computer	TCI Micro Computer
STARTING SYSTEM	Electric	Electric	Electric	Electric	Electric	Electric	Electric	Electric
SHAFT LENGTH	25" 30"	25" 30" <sup>†</sup>	25"	20' 25"	20' 25"	20' 25"	20' 25"	20' 25" <sup>††</sup>
GEAR RATIO	1.79 (21:14)	1.75 (21:12)	1.86 (26:14)	1.86 (26:14)	2.00 (28:14)	2.00 (28:14)	2.15 (28:13)	2.15 (28:13)
CARB. RATING	H H H 3-Star	H H H 3-Star	H H H 3-Star	H H H 3-Star	H H H 3-Star	H H H 3-Star	H H H 3-Star	H H H 3-Star
WEIGHT*	432 kg (952lb)	250 kg (551lb)	221 kg (487lb)	219 kg (483lb)	219 kg (483lb)	217 kg (478lb)	171 kg (377lb)	162 kg (357lb)

Legend on page 21

SPECIFICATIONS

FOUR STROKES								
MODEL	F70	F60 F50	F40 F30	F25 F20	F15	F9.9	F8	F6 F4
ENGINE TYPE	4cyl	4cyl	3cyl	2cyl	2cyl	2cyl	2cyl	1cyl
DISPLACEMENT	996 cc (60.8ci)	996 cc (60.8ci)	747 cc (45.6ci)	432 cc (26.4ci)	362 cc (22.1ci)	212 cc (12.9ci)	212 cc (12.9ci)	139 cc (8.4ci)
RPM RANGE	5,300- 6,300	5,000- 6,000	5,000- 6,000	5,000- 6,000	5,000- 6,000	5,000- 6,000	5,000- 6,000	4,500-5,500- F6 4,000-5,000- F4
ALTERNATOR OUTPUT@ W.O.T.	17A	16A	17A	16A	10A **	6A **	6A **	6A **
COMPRESSION RATIO	9.4:1	9.5:1	9.4:1	9.3:1	9.3:1	9.5:1	9.4:1	8.9:1
FUEL/ INDUCTION SYSTEM	16valve SOHC Fuel Injection	SOHC Fuel Injection	SOHC Fuel Injection	SOHC Fuel Injection (batteryless)	SOHC/ CARB	SOHC/ CARB	SOHC/ CARB	OHV/ CARB
LUBRICATION	Wet Sump	Wet Sump	Wet Sump	Wet Sump	Wet Sump	Wet Sump	Wet Sump	Wet Sump
IGNITION SYSTEM	TCI Micro Computer	TCI Micro Computer	TCI Micro Computer	TCI Micro Computer	CDI Micro Computer	CDI Micro Computer	CDI Micro Computer	CDI
STARTING SYSTEM	Electric	Electric	Electric	Manual or Electric with Manual Backup	Manual or Electric	Manual or Electric	Manual	Manual
SHAFT LENGTH	20"	20"	20"	15" 20"	15" 20"	15" 20"	15" 20"	15" 20"
GEAR RATIO	2.33 (28:12)	1.85 (24:13)	2.00 (26:13)	2.08 (27:13)	2.08 (27:13)	2.08 (27:13)	2.08 (27:13)	2.08 (27:13) F/N
CARB. RATING	H H H 3-Star	H H H 3-Star	H H H 3-Star	H H H 3-Star	H H H 3-Star	H H H 3-Star	H H H 3-Star	H H H 3-Star
WEIGHT*	115 kg (253lb)	112 kg (247lb)	97 kg (214lb)	57 kg (126lb)	50 kg (111lb)	40 kg (88lb)	40 kg (88lb)	27 kg (59lb)

\*B Generation



SPECIFICATIONS

V MAX SHO(4 STROKES)							HIGH THRUST (4STROKES)			JETDRIVE (4 STROKES)					
MODEL	VF250 VF200	VF225	VF175	VF150	VF115	VF90	T60 T50	T25	T9.9	MODEL	F150 (105 HP)	F115 (80 HP)	F90 (65 HP)	F60 (40 HP)	F40 (30 HP)
ENGINE TYPE	V6(60°)	V6(60°)	4cyl	4cyl	4cyl	4cyl	4cyl	2cyl	2cyl	ENGINE TYPE	4cyl	4cyl	4cyl	4cyl	3cyl
DISPLACEMENT	4,169 cc (254.4c)	4,169 cc (254.4c)	2,785 cc (163c)	2,785 cc (163c)	1,832 cc (111.8c)	1,832 cc (111.8c)	996 cc (60.8c)	432 cc (26.4c)	212 cc (12.9c)	DISPLACEMENT	2,670 cc (163c)	1,832 cc (111.8c)	1,832 cc (111.8c)	996 cc (60.8c)	747 cc (45.6c)
RPM RANGE	5,000- 6,000	5,000- 6,000	5,000- 6,000	5,000- 6,000	5,300- 6,300	5,000- 6,000	5,000- 6,000	5,000- 6,000	5,000- 6,000	RPM RANGE	5,000- 6,000	5,300- 6,300	5,000- 6,000	5,000- 6,000	5,000- 6,000
ALTERNATOR OUTPUT@ WOT.	50A	50A	50A	50A	35A	35A	16A	16A	6A	ALTERNATOR OUTPUT@ WOT.	35A	35A	35A	17A	16A
COMPRESSION RATIO	103:1	103:1	103:1	103:1	100:1	100:1	95:1	93:1	95:1	COMPRESSION RATIO	90:1	100:1	100:1	95:1	94:1
FUEL/ INDUCTION SYSTEM	DOHC Fuel Injection VCT	DOHC Fuel Injection VCT	DOHC Fuel Injection VCT	DOHC Fuel Injection VCT	DOHC Fuel Injection	SOHC Fuel Injection	SOHC Fuel Injection	SOHC/ Fuel Injection	SOHC/ CARB	FUEL/ INDUCTION SYSTEM	DOHC Fuel Injection	DOHC Fuel Injection	SOHC Fuel Injection	SOHC Fuel Injection	SOHC Fuel Injection
LUBRICATION	Wet Sump	Wet Sump	Wet Sump	Wet Sump	Wet Sump	Wet Sump	Wet Sump	Wet Sump	Wet Sump	LUBRICATION	Wet Sump	Wet Sump	Wet Sump	Wet Sump	Wet Sump
IGNITION SYSTEM	TCI Micro Computer	TCI Micro Computer	TCI Micro Computer	TCI Micro Computer	TCI Micro Computer	TCI Micro Computer	TCI Micro Computer	CD Micro Computer	CD Micro Computer	IGNITION SYSTEM	TCI Micro Computer	TCI Micro Computer	TCI Micro Computer	TCI Micro Computer	TCI Micro Computer
STARTING SYSTEM	Electric	Electric	Electric	Electric	Electric	Electric	Electric	Electric	Manual or Electric	STARTING SYSTEM	Electric	Electric	Electric	Electric	Electric
SHAFT LENGTH	20' 25"	20'	20' 25"	20' 25"	20' 25"	20' 25"	20'	20' 25"	20' 25"	SHAFT LENGTH	Fits 25"	Fits 25"	Fits 25"	Fits 25"	Fits 20'
GEAR RATIO	1.75 (21:12)	1.75 (21:12)	1.86 (26:14)	2.00 (28:14)	2.15 (28:13)	2.33 (28:12)	2.33 (28:12)	2.08 (27:13)	2.92 (38:13)	GEAR RATIO	N/A	N/A	N/A	N/A	N/A
CARB. RATING	H H H 3-Star	H H H 3-Star	H H H 3-Star	H H H 3-Star	H H H 3-Star	H H H 3-Star	H H H 3-Star	H H H 3-Star	H H H 3-Star	CARB. RATING	H H H 3-Star	H H H 3-Star	H H H 3-Star	H H H 3-Star	H H H 3-Star
WEIGHT*	229kg (505lb)	229kg (505lb)	218kg (480lb)	218kg (480lb)	171kg (377lb)	160kg (353lb)	116kg (256lb)	66kg (145lb)	42kg (93lb)	WEIGHT*	225 kg (495lb)	171kg (378lb)	162 kg (357lb)	116kg (257lb)	99kg (214lb)



Behind every outboard we make stands one of the most comprehensive limited warranty coverages available. Yamaha four strokes come standard with a three-yearlimited warranty for pleasure use.

- † Only available on F300 and F250 models  
†† Only available on F90 models  
\* Weight refers to lightestavailable specification.  
Weight includes propeller where standard.  
\*\* Consultyour dealer for optional equipment.  
Digital control model also available

F2.5-F/T25come standard with an aluminum propeller.  
All DOHC, F90, F75 and F70 engines have 4 valves per cylinder.  
“CARB.” is used to indicate a carbureted engine  
“C.A.R.B.” is used to indicate California Air Resources Board  
DEC =Digital Electronic Control  
MECH =Mechanical Control

Due to Yamaha’s ongoing commitment to product improvement, we reserve the right to change without notice, equipment, materials or specifications. Your Yamaha Dealer is the best source for up-to-dateproduct information.  
Read and follow the operation and maintenance guidelines provided by Yamaha in your Owner’s Manual.  
Always observe all applicable boating laws. Never drink and drive. Dress properly with a CCG–approvedpersonal floatation device and protective gear.



# RELIABILITY & DURABILITY

## CORROSION PROTECTION

Combined with our proprietary alloy (YDC-30), our highly vaunted, anti-corrosive paint system provides a tough, five-layer barrier against corrosion. Stainless Steel components such as the drive, prop and shift shafts provide an additional layer of critical corrosion protection. And multiple sacrificial anodes throughout the motor provide protection from the elements.

## CORROSION PREVENTION



YDC30, marine aluminum alloy



stainless steel water pump



Multiple sacrificial anodes



Stainless steel water tube



Heavy duty anodized muffler



Freshwater flushing device

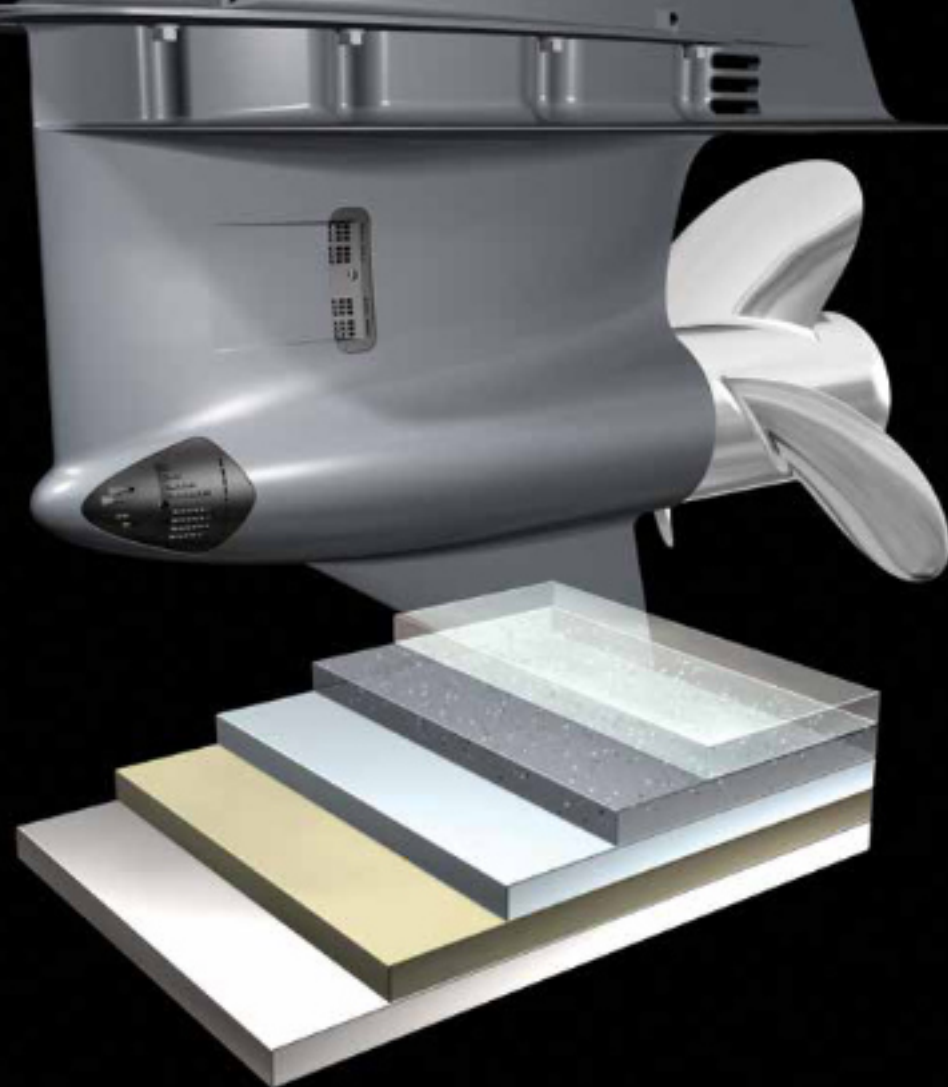

**GENUINE**  
Parts & Accessoires  
Pièces et accessoires

## THE PERFECT FIT

Count on Genuine Yamaha Parts & Accessories for superior quality and style when it comes to your outboard. Designed for recreational boaters, anglers, outdoorsmen, and fishermen just like you. Genuine Yamaha Parts & Accessories will exceed your performance demands and are the perfect fit & finish for your Yamaha.

## WANT TO SEE MORE?

Shop thousands of genuine Yamaha parts, accessories, and apparel directly online today.

**YAMAHA-MOTOR.CA**

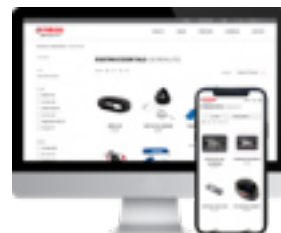

## ACCESSORIES

### | ANALOG AND DIGITAL GAUGES



### | IGNITION SWITCHES



### | GENUINE YAMAHA PROPELLERS



### | CONTROL CABLES



### | SINGLE AND TWIN CONTROLS



### | WIRE HARNESSES

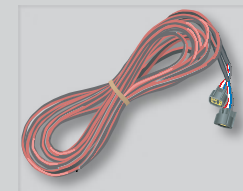

### | FUEL FILTERS



### | SPLASH COVERS



### | ALUMINUM AND MAGNESIUM ANODES

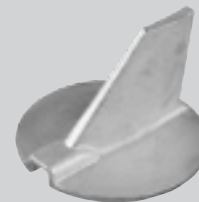



## THE POWERMATCHED™ SYSTEM LIMITED WARRANTY

### YAMAHARELIABILITY FROM STEM TO STERN

#### INNOVATION / RELIABILITY / CONVENIENCE

Put a PowerMatched System in your new boat, and you'll not only maximize your boat's reliability and performance, you'll have the added confidence of Yamaha's new PowerMatched System Limited Warranty. The warranty on your entire power system will match the length of your outboard's warranty — a full three years on Yamaha 4-strokes.

The Yamaha PowerMatched System Limited Warranty is available on new boat purchases only, at authorized participating dealers and boat partners nationwide. Simply have these key components installed: Yamaha gauges, key switches, remote controls, wiring harnesses, fuel filters, and control cables. Unlike aftermarket alternatives, they're designed by Yamaha exclusively for Yamaha outboards. They're engineered to fit together, and to work together. And they're always manufactured from the finest materials to Yamaha's stringent quality standards.

Want to get the most from your boating investment? Demand the peace of mind and protection you deserve for your boat and your Yamaha outboard.

Insist on the Yamaha PowerMatched System with your Yamaha outboard and have the confidence of a PowerMatched System Limited Warranty that matches the length of your outboard warranty.

For complete details on the PowerMatched System, see your authorized participating Yamaha dealer, or visit [www.yamaha-motor.ca](http://www.yamaha-motor.ca) today.

## GAUGES

### With Yamaha gauges, everyone is a know-it-all

Yamaha instrumentation puts all vital system information right at your fingertips. You know they're accurate, because they're designed for your Yamaha outboard. They're easy to read and engineered to withstand the elements. Command Link Digital Gauges are compatible with Yamaha four strokes F20 and up. They give you access to more information, using fewer gauges, and they allow you to configure the information any way you want. You have the choice of a full range of Yamaha Digital Multifunction Gauges and Pro Series II™ Analog Gauges. Choose from Tachometers, Speedometers, Fuel Management gauges, or combination Speedometer/Fuel Management gauges. Use Yamaha instrumentation with all of the other Yamaha power system components, and you've got the reliability of a PowerMatched System.



#### Analog accurate, easy-to-read

There's a highly accurate, easy-to-read Yamaha Pro Series II™ Analog Gauge to provide every type of system information. They're illuminated for easy nighttime viewing, and the tachometers feature built-in oil and temperature warning lights. Available in black or white face plate.



#### Digital versatility, at the touch of a button

Yamaha Digital Multifunction Gauges provide multiple system readings at the touch of a button. Advanced instrumentation is designed to keep you informed about your engine's systems. Fine-tune settings to achieve the best overall efficiency and performance for your operating conditions.

### The Power of Information

#### Pack more data into fewer gauges

Command Link Digital Gauges pack more data into fewer gauges, conserve dash space, give you even greater control of your craft and put you in charge of the water and your boating experience. Enjoy instant data on boating conditions and all of your system's vital information — right at your fingertips. Command Link relays more information, features crisp LCD readouts, customizable displays and gives you real-time updates on everything from engine functions, fuel use/management and oil levels to trim levels, battery charge and even maintenance reminders.

#### More information at your fingertips

Have more information at your fingertips than ever before. Displays are user-selectable, so you can choose the functions displayed on each gauge, and in what order. An optional Triducer® also monitors speed, depth and surface water temperature. Having this information gives you the power to adjust your engine's performance to match boating conditions and that means optimal boating efficiency. As fuel costs are a continuous concern, efficiency has never been more important.

**Command link**







**Command link**  
**+PLUS**

Today, you want more information than ever before. Yamaha is proud to announce the new Command Link Plus rigging system. With more convenience, flexibility and information than ever before, Command Link Plus and Command Link represent the absolute leading edge of Yamaha rigging technology. All with the level of innovation and reliability you've come to expect from Yamaha. With the new "Command Link Plus," you've got it! Welcome aboard!

**Command Link Plus Displays**

CL7 Yamaha's CL7 display features a seven-inch touch panel with full multi-function display (MFD) capability and connectivity. It offers precise engine and boat systems data for up to four outboards on one screen, along with other MFD functions, such as maps, fish finder and graphing capabilities through its built-in 10 MHz GPS unit.



CL7 Seven-inch touch panel with full MFD capability and connectivity

For complete details on the PowerMatched System, see your authorized participating Yamaha dealer, or visit [www.yamaha-motor.ca](http://www.yamaha-motor.ca) today.

CONTROLS

PowerMatched puts you in control

Fingertip Control

Yamaha puts command at your fingertips with a full array of sleek, ergonomic, smooth-operating controls. Whether you're captain of a dual-engine cruiser or a backwater jon boat, you want easy, effortless control of your craft. It doesn't matter if you're running 425 horses or 30; you'll want the performance of a Yamaha PowerMatched System. Yamaha's advanced engine controls have a sleek, ergonomic design, giving you one-hand operation of both shift and throttle functions. On multi-engine controls, a single thumb-operated button trims all engines, and the neutral/warm-up button is nestled conveniently on the handle. The externally adjustable throttle friction and our new-generation internal mechanism give you exceptionally smooth operation. Yamaha Premium Binnacle Controls have a polished chrome finish to add a touch of style to any boat, and they're available in single and twin configurations.

Conventional Remote Controls

704 PREMIUM TWIN BINNACLE	704 PREMIUM SINGLE BINNACLE	704 STANDARD SINGLE BINNACLE	6X0 FLUSH SIDE-MOUNT
6X3 PREMIUM FLUSH SIDE-MOUNT	703 PREMIUM SIDE-MOUNT	703 REVERSE CONFIGURATION A new rotatable grip allows operation of the power trim and tilt switch with the thumb of either hand for operator comfort and ease of use.	

**Command link**  
**+PLUS**

**Command Link Plus Digital Electronic Controls (DEC)**  
The Command Link and compatible controls offer virtually effortless throttle and shift functions, highly polished chrome handles, and a built-in redundancy system for added reliability. Thanks to 'plug-and-play' convenience, adding a second station control is a breeze. Additionally, all multiple engine Command Link DEC's feature automatic engine rpm synchronization.

CommandLink & Command link Plus  
Digital Electronic Binnacle Controls

6X6 SINGLE-ENGINE	6X6 TWIN-ENGINE	6X7 FLUSH-MOUNT
6X9 SINGLE-ENGINE	6X9 TWIN-ENGINE	

ACCESSORIES

SWITCHES

Now that's a switch!

Yamaha offers a full range of ignition switches, engineered for maximum durability and reliability. Single switches. Dual switches. Stop switches. Combination switches. Because we know your outboard, we offer a variety of mounting configurations — and because they're Yamaha, you know they'll fit and perform without a hitch. Working hand in hand with all the other Yamaha power system components, Yamaha ignition switches ensure you have the reliability of a PowerMatched System, with every turn of the key.

Reliability

Yamaha Ignition Switches are ergonomically designed for comfort, and are compact to put control within easy reach. These are the switches designed expressly for use with your Yamaha outboard engine, with Yamaha's uncompromising quality in materials and workmanship.



For complete details on the PowerMatched System, see your authorized participating Yamaha dealer, or visit [www.yamaha-motor.ca](http://www.yamaha-motor.ca) today.

Command Link Plus Key Switches

Yamaha's new Command Link Plus key panels offer the latest in technology and durability, with a new ergonomic key design and new functionality. All except for the single engine ignition switch are "key" panels, which energize the ignition system of multiple outboards with only one key.

Command Link Plus Start/Stop Panels

The appropriate start/stop panel is used in conjunction with the correct key panel for the application and greatly simplifies the starting and stopping process of the outboards. There's even an "All Engine" start/stop button, which allows multiple engines to be started successively or stopped simultaneously with the touch of a single button.



FUEL FILTERS & POWERMATCHED

YamahaFuel Filters — the ultimate protection

Your fuel filter plays a crucial role in your engine's performance, reliability and long life. Yamaha designed your outboard, and we know what it takes to protect it. Our 10-MicronFuel Filters filter out contaminants and separate water from the fuel, ahead of the onboard filters and injectors. They have a high-performance flow rate and a much larger filtering surface than other filters on the market, and they're manufactured to strict Yamaha standards. Use them along with all of the other Yamaha power system components for the dependability of a totally PowerMatched System.

PowerMatched Protection

Our 10-MicronFuel/Water Separating Filter is designed for EFI four-stroke and HPDI two-stroke outboards, and also offers excellent protection for carbureted engines. Yamaha's filter technology ensures maximum filtration while maintaining adequate flow rate, and features an aluminum head.

PowerMatched Protection — 115 hp and under

mini10™ Fuel/Water Separating Filters ensure a high-performance flow rate to keep small and mid-range engines running smooth. The filter is made from coated steel on the inside, painted steel outside, for added corrosion resistance, and features an aluminum head.



PowerMatched delivers total confidence

Unrivalled Smoothness

Yamaha Remote Control Cables set the standard with an advanced technology that reduces friction for excellent cable performance and smooth operation. These cables have a special friction-reducing design for smoothness. We've designed them to provide more strength and less bend radius than ordinary cables, with a UV-stabilized jacket that resists cracking, for added water resistance. Yamaha Controls Cables — a vital part of the total confidence that comes when every piece of your power system is PowerMatched.

Simplify Your Life

With all Yamaha wiring harnesses, rigging your boat is virtually "plug and play." Installation and service is a breeze. All connections are colour-coded and like-sized so they fit together, work together. And all Yamaha wiring harness connections are either rubber-coated or O-ring sealed for maximum corrosion protection. These are the harnesses made to order for your Yamaha power system; there's no need to splice, or guess at proper connections. They are designed by Yamaha, for Yamaha, and are a key component of the Yamaha PowerMatched System.

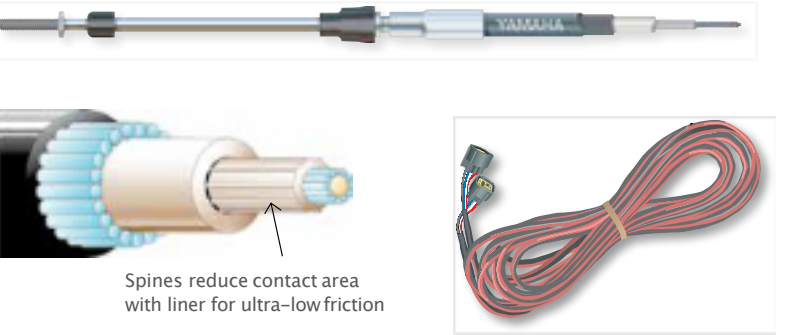



## ACCESSORIES

### PROPS

#### The Evolution of the Prop

As our legendary line of outboards continues to evolve, so does our line of propellers. Tapping into proprietary information, Yamaha's engineers continue to design and refine props that push the performance of both existing and emerging marine technology to previously unimaginable levels with dedication to developing the perfect propeller for each outboard and boating application. Want to see what your outboard is capable of? Pair it with a flawlessly engineered and meticulously manufactured Yamaha propeller.

#### Revolutionizing your boating experience

Yamaha's patent-pending Shift Dampener System™ uses a unique rubber hub to distribute and absorb the forces, as well as the resulting sounds and vibrations, normally associated with shifting an outboard into gear. The result: far quieter and smoother, 'clunk-free' shifting. "Amazing" is the word most often used to describe the result.

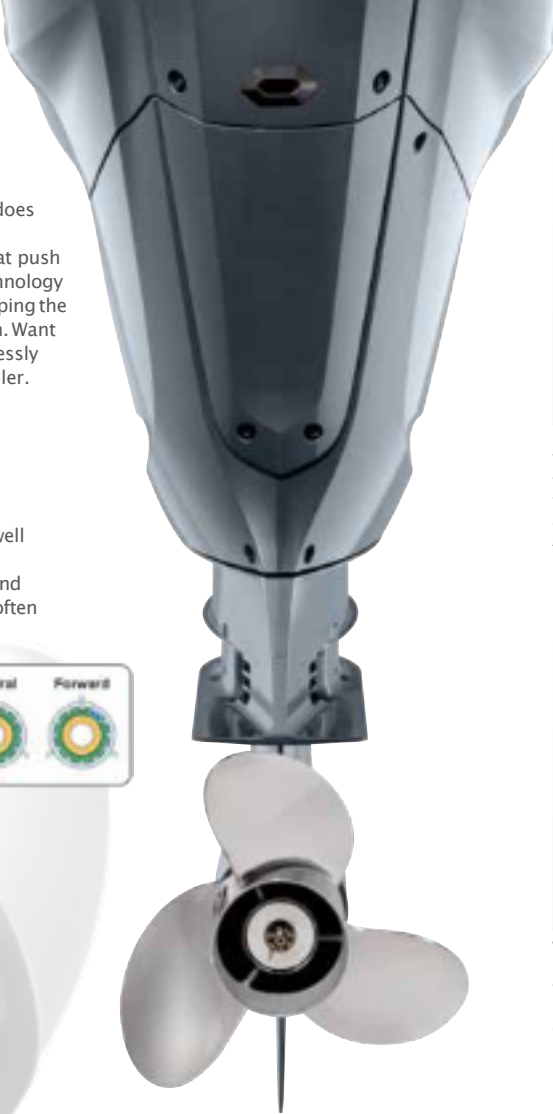
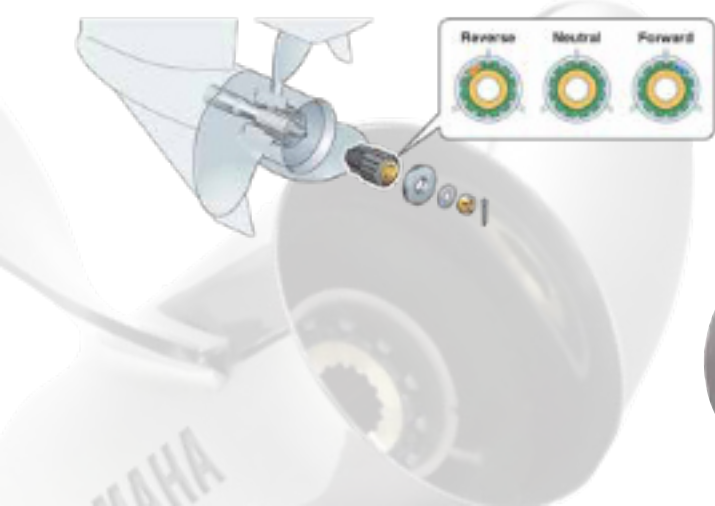

#### NEW! XTO OS™ PROPELLERS

Yamaha's new family of XTO OS Propellers are made to complement the torque potential of the Yamaha XTO and specifically designed for moving really big boats. With new stainless steel material, they are also more resistant to corrosion and surface discoloration. Available in 15", 17", 19", 21", 23", and 25" pitches in both right- and left-hand rotation.



#### TALON SS4

Introducing Yamaha's new Talon SS4 – a unique propeller solution that combines four-blade acceleration and lifting capability with a stealthy approach. Talon SS4 propellers fit Yamaha's line of powerful, quiet four stroke mid-range outboards from T50 through F115, in 14", 16", 18", 20", 22" and 23" pitches in right-hand rotation only.



#### TALON GP™ (available in SDS)

The Talon GP SDS is an entirely new aluminum propeller developed in conjunction with Yamaha's new F90. Perfect for general purpose use, the Talon GP SDS offers strong acceleration and grip along with the quiet, smooth operation of SDS. Available in 14" to 18" pitches in right-hand rotation only.



#### ALUMINUM SERIES

Light weight and lower cost makes an aluminum propeller a popular choice. It's important to remember that Yamaha aluminum propellers provide better performance with your Yamaha outboard. An aluminum prop also makes an excellent choice as a spare, in the event your primary prop becomes damaged.



#### TALON SERIES (available in SDS)

Specifically designed for Yamaha mid-range outboards, this series of stainless steel propellers features an all-new blade architecture that can be used for pontoon, walleye, deep V and fiberglass boats. These props have a new, replaceable SDS hub that requires no special hardware for proper operation. Available in 9", 10.5", 12", 14" and 16" pitches in right-hand rotation only.



#### DUAL THRUST SERIES

The answer for heavy loads such as sailboats and pontoons. There's even a High-Thrust™ with a large diameter and low pitch (14 x 11), designed especially for use with the Yamaha T50/T60 on a pontoon boat.



#### TALON TM SS SERIES (available in SDS)

The Talon SS SDS series combines quiet shifting and smooth in-gear operation (even at low speeds) with a high-performance stainless steel propeller – a first for midrange outboards. Available in 14", 16", 18" and 20" pitches in both left- and right-hand rotation, and in 19", 22" and 24" pitches in right-hand rotation only.



#### PAINTED STAINLESS STEEL SERIES

A great all-purpose prop, its stainless steel construction allows for a blade that's thinner, more efficient and more durable than an aluminum propeller. Available in right- and left-hand rotation.

ACCESSORIES



**SALTWATER SERIES XL\*\***  
(available in SDS)  
Designed exclusively for Yamaha V8 outboards. They feature 21% more blade area than Saltwater Series II™, minimize ventilation, and provide large, offshore boats with amazing power to plane, acceleration and top end. Available in five pitch sizes from 15" to 23", in both right-and left-hand rotation.



**SALTWATER SERIES HS4**  
(available in SDS)  
Intended for use with our V6 four-strokes and 200-300hp two-strokes in specific applications. Expect outstanding acceleration, improved "grip" to help maintain plane at lower engine speeds, and better resistance to ventilation in high seas. Available in 21", 22", and 23" pitches, in both right-and left-hand rotation.



**SALTWATER SERIES II™**  
(available in SDS)  
These propellers feature a large diameter, steep rake and added blade cup, for superior midrange fuel efficiency and reduced ventilation. That means improved cruising range and better handling in rough water. Available in 13", 15", 17", 19", 21" and 23" pitches, in both right-and left-hand rotation.



**PRO SERIES™**  
A high rake, progressive pitch and aggressive cupping deliver excellent midrange and top-end performance. It's a popular choice for single-engine, high-speed boats that require "bow lift" and a high engine-mount. Available in four pitches. Right-hand rotation only.



**RELIANCE® SERIES**  
(available in SDS)  
This series was initially designed for the popular F150, but provides excellent performance on outboards up to 300hp. The innovative blade design improves handling and turning and delivers more speed at all rpms, excellent anti-ventilation and better "grip" to boost bow lift and top-end speed.\*\* Available in 13" to 23" pitches in both right and left-hand rotation.



**V MAX SERIES (VENTLESS)**  
The next evolution of our V MAX Ventless Series props, the V MAX SHO Series provides outstanding acceleration, top-end and handling for high-performance bass, bay, and flats boats. Their ventless design specifically enhances the operation of our four-stroke V MAX SHO models. Available in a wide range of single-inch pitches to achieve peak performance.



**TALON PONTOON SERIES**  
Features a notably larger blade area to provide the thrust and control larger pontoons demand, while adding "grip" and reducing ventilation in turns. Available in 9", 10", 11", 12" and 13" pitches. These props pair well with T50, T60, F70-F115 four-strokes and 60-130hp two-strokes.

ACCESSORIES





# DEVELOPED BY YAMAHA FOR YAMAHA

Discover the full line of Yamalube® products specifically designed for your Outboard.



## Marine Gearcase Lubricant HD

Specially formulated for Yamaha V6, V8 and VMAX SHO outboard motors. Fortified with additives to withstand the extreme gear contact pressure. Special rust and corrosion inhibitors protect bearings and internal parts from the harshest marine environments.



## RingFree Plus

Removes carbon and protects fuel system metals from ethanol fuel corrosion. 100 ml travel size treats 19 L of fuel. 355 ml bottle treats up to 355 L of fuel.



## Fuel Stabilizer & Conditioner PLUS

Helps resist phase separation, deters ethanol corrosion and keeps stored fuel fresh. 100 ml travel size treats 19 L of gas.



## Marine Grease

Lithium-soap-based grease that prevents corrosion and rust, and resists wash-off, extreme heat, pressure and the effects of a harsh marine environment.



## Silicone Spray Protectant & Lubricant

General-purpose lubricant helps protect metal against rust and corrosion. Conditions and protects neoprene, rubber and other surfaces from environmental effects.



## Yamalube® 10W-304M Engine Oil

A top-tier, NMMA® FC-W®-certified oil, 4M provides maximum rust and corrosion protection and cooler temperatures in advanced, four stroke outboard engines operating at varying loads, in a range of marine conditions.

## DIY with Oil Change Kits

Give your Yamaha the protection it deserves with a Yamalube® Oil Change Kit. Each kit includes the necessary oil, oil filter and drain washer required to get the job done. Pick up your kit at your local Yamaha dealer or online at [yamaha-motor.ca](http://yamaha-motor.ca).



WE'RE ENTHUSIASTS TOO. **WEGETYOU**

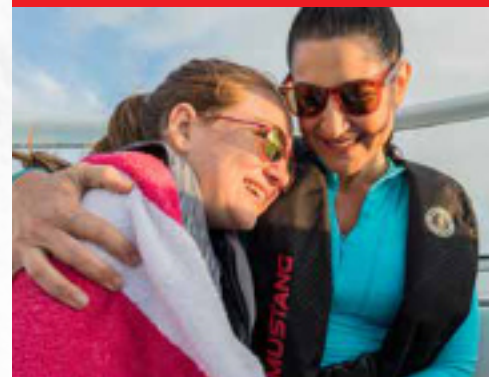

## Make Your Dream a Reality.

Learn more about our flexible payment options and special offers at [Yamaha-Motor.ca](http://Yamaha-Motor.ca).



## FIVE STAR DEALER PROGRAM

Throughout the world, the designation of Five Stars is synonymous with the pinnacle of quality. The Yamaha Five Star Dealer program is designed to identify those dealers committed to providing the best end-to-end customer service in the industry.

To Yamaha, this means clean, inviting showrooms, friendly and efficient salespeople, and the best in customer satisfaction.

Approximately 100 dealers have achieved the prestigious Five Star status.

VISIT [YAMAHA-MOTOR.CA](http://YAMAHA-MOTOR.CA) TO LOCATE THE NEAREST FIVE STAR DEALER.



Items and specifications subject to change without notice. Yamaha Motor Canada proudly offers and acknowledges quality products manufactured by reputable companies throughout this brochure. All other company and/or product names are trademarks or registered trademarks of their respective holders.





Some U.S. models shown. Your Yamaha dealer is the best source for up-to-date product information. Read and follow the operation and maintenance guidelines provided by Yamaha in your owner's manual. Always observe all applicable boating laws. Never drink or take drugs and ride. Dress properly with a CCG-approved personal flotation device. Yamaha recommends all riders take an approved safety training course.

Yamaha Motor Canada Ltd. reserves the right, at any time, to discontinue or change specifications, prices, designs, features, accessories or equipment without incurring any obligation or liability. Although the content of this brochure is believed to be accurate at time of printing, precision cannot be guaranteed. Some images depicted herein may include optional equipment or are sold separately. Prices are based on Manufacturer's Suggested Retail Prices. Dealers are at liberty to set their own pricing. Taxes and installation of accessories are not included in prices shown. See your Yamaha dealer for the most up-to-date and accurate information.

This document contains many of the valuable Trademarks and service marks owned and used by Yamaha throughout the world. This document may also contain references to other company brand and product names that may be the trademarks/service marks of their respective owners. These company brand and product names are used herein for identification purposes only, and references to any names, marks, products or services of third parties do not constitute or imply endorsement, sponsorship or recommendation of the third party or the products or services.

Yamaha Motor Canada Ltd., 480 Gordon Baker Road, Toronto, ON M2H 3B4



**BRIDGE YACHTS LTD.**  
**SHIP'S STORE & YACHT BROKERS**  
 49 Harbour St. Port Dover, Ontario N0A 1N0  
 Tel: (877)583-3199 [www.BridgeYachts.com](http://www.BridgeYachts.com)

